

MASTEEL TOOLING

≡ Masteel Shear Quality Blade

- Material:
High carbon
High chrome
With shock resistance
- Heat Treatment:
HR C58 ~ 60

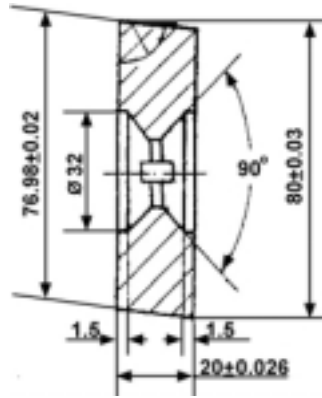

TOP BLADE MSB0-T800

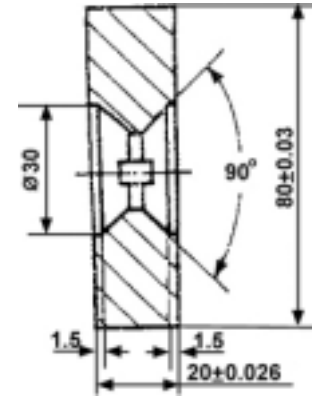

BOTTOM BLADE MSB0-B800

≡ Masteel Punches

- **Gooseneck Punch**
Model: MP0-G800

Standard for All Masteel Brake

Material: Tool Steel T8
Hardened and precision ground
Hardened to 53-58RC
Capacity: 100 Ton/M (33 Ton/Ft)



- **Gooseneck Punch**
Model: MP1-G800

Material: Tool Steel T8
Hardened
And precision Ground
Hardened to 53-58RC
Capacity: 50 Ton/M
(16 Ton/Ft)

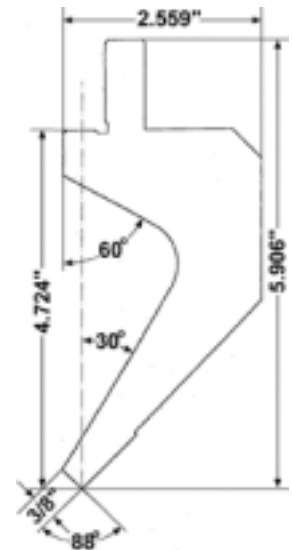

- **30° Forming punch**
Model: MP-F800

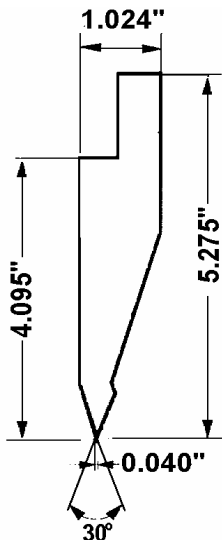

- **Hemming punch**
Model: MP-H800

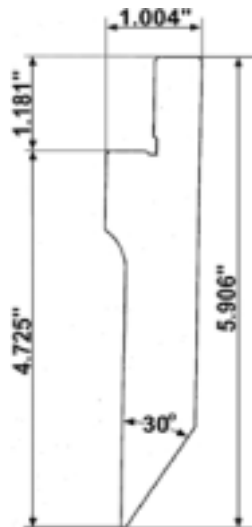

- **Flattening punch**
Model: MP-FL800

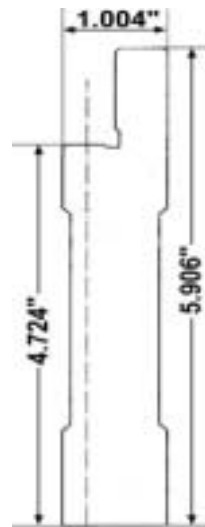

Material: Tool Steel T7A
Hardened and precision
ground
Hardened to 53-58RC

≡ Masteel 4-Way Dies

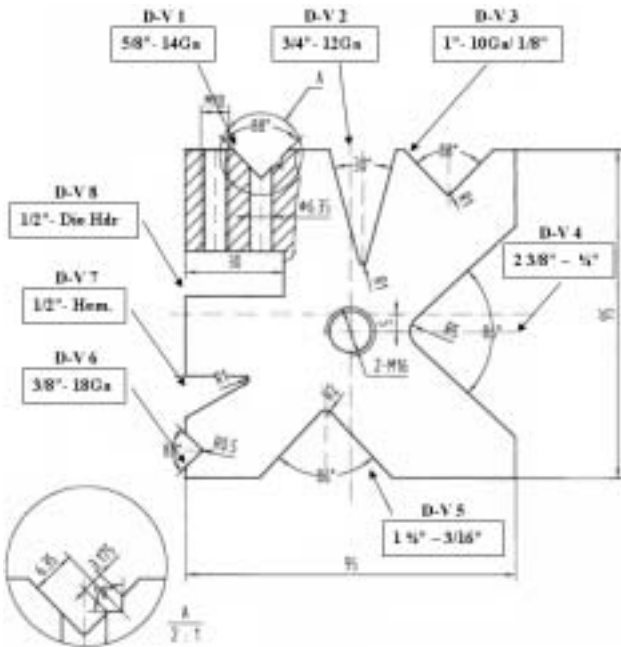

**Model: MD-4W4, 3.740" Square
Standard for 110 & 160 Ton**

Die Open #	Dimension	Used For
D-V 1	0.625"	14Ga.
D-V 2	0.75"	12Ga.
D-V 3	1.000"	10Ga./ 1/8"
D-V 4	2.375"	1/4"
D-V 5	1.500"	3/16"
D-V 6	0.375"	18Ga.
D-V 7	0.5"	Hem. Die
D-V 8	0.5"	Die Holder

- Material: T7A or #70
- Hardened and precision ground
- Hardened to: HB190-260

**Model: MD-4W5, 4.330" Square
Standard for 200 Ton & above**

Die Open #	Dimension	Used For
D-V 1	0.625"	14Ga.
D-V 2	0.75"	12Ga.
D-V 3	1.250"	10Ga.& 0.1875"
D-V 4	3.375"	3.375"
D-V 5	2.250"	1/4"
D-V 6	0.375"	18Ga
D-V 7	0.500"	Hem. Die
D-V 8	0.500"	Die holder

- Material: T7A or #70
- Hardened and precision ground
- Hardened to: HB190-260

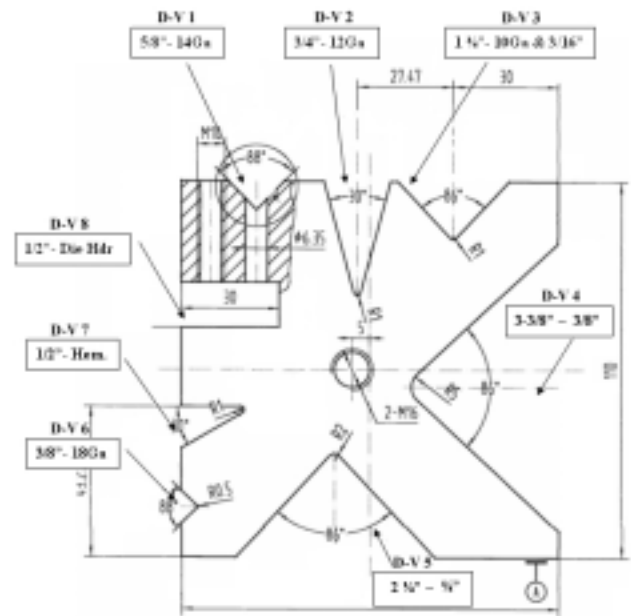

Model: MD-4W6

Die Open #	Dimension	Used For
D-V 1	5.000"	1/2"
D-V 2	2.250 "	1/4"
D-V 3	3.375"	3/8"
D-V 4	0.625"	14Ga.
D-V 5	0.500"	Die Holder
D-V 6	0.750"	12Ga.
D-V 7	1.250"	10Ga. & 3/16"

- Material: T7A or #70
- Hardened and precision ground
- Hardened to: HB190-260

